

The former Lye & Wollescote Cemetery Chapels ~

# The Thomas Robinson Building

**HISTORY in the HEADSTONES**  
The Lye & Wollescote Cemetery Trail

The former Chapels building is a classic example of Gothic Revival architecture of the Victorian period. Designed by Stourbridge architect, Thomas Robinson, and constructed by C.A. Horton of Brierley Hill, the building was completed in 1878 and, along with the burial ground, was officially opened in 1879. A central entrance opened onto two separate chapels: Nonconformist and Anglican.

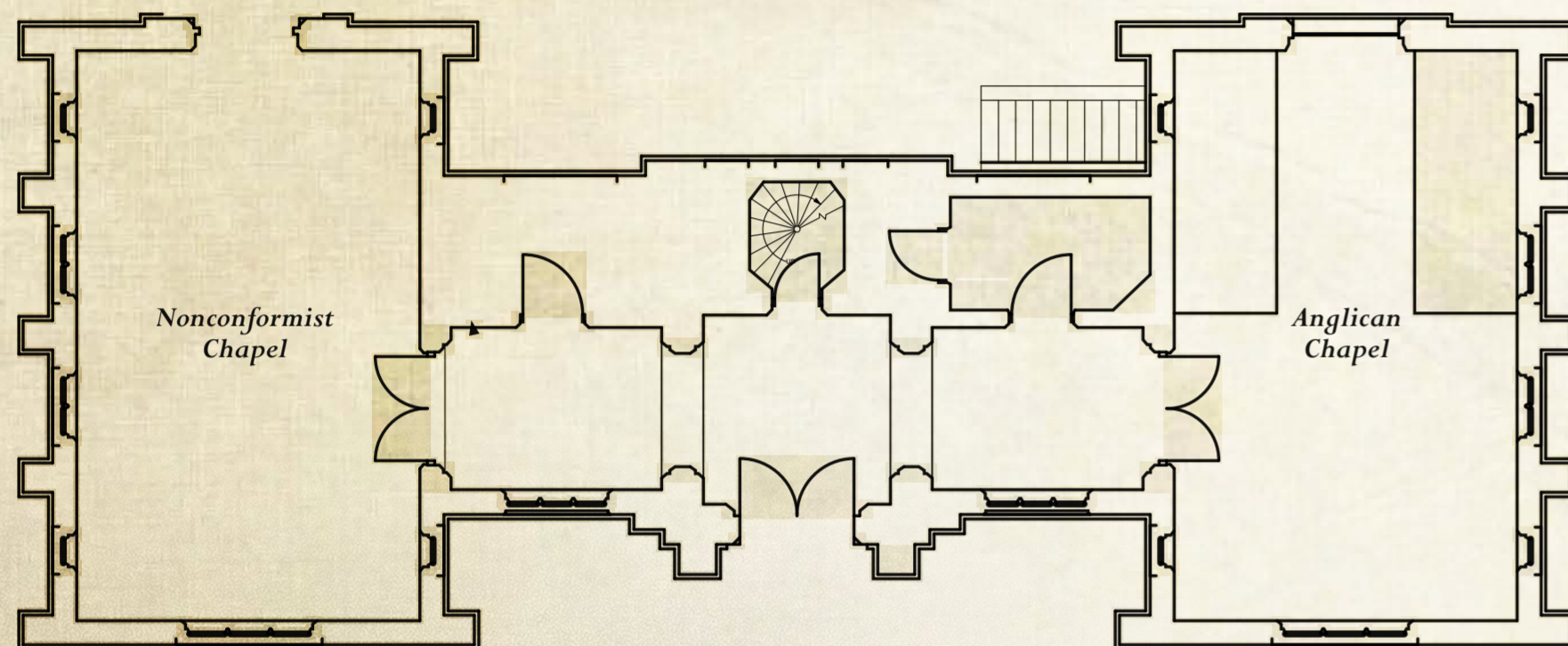

ABOVE: The original floorplan of The Lye & Wollescote Cemetery building, showing the separate Nonconformist and Anglican Chapels.

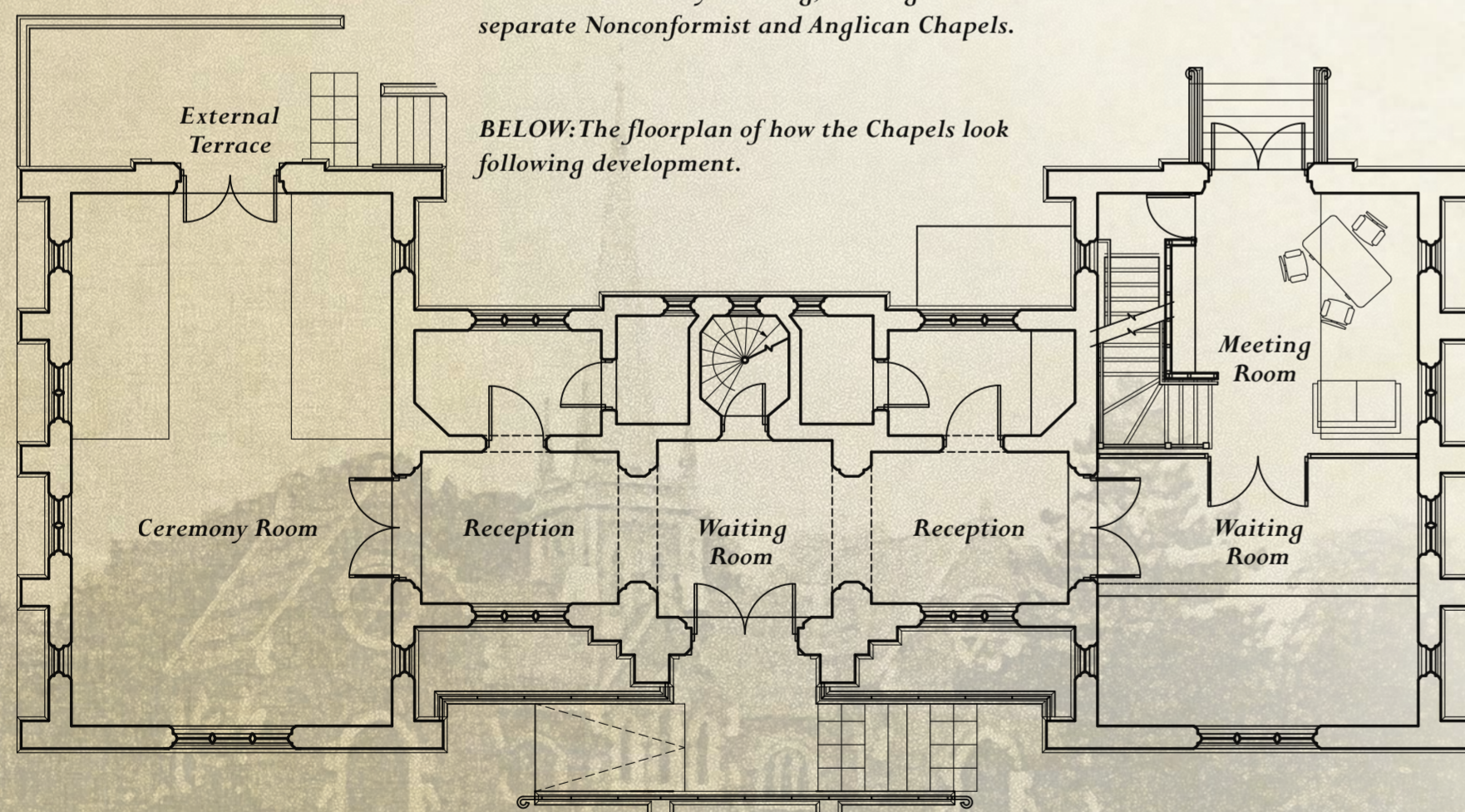

BELOW: The floorplan of how the Chapels look following development.

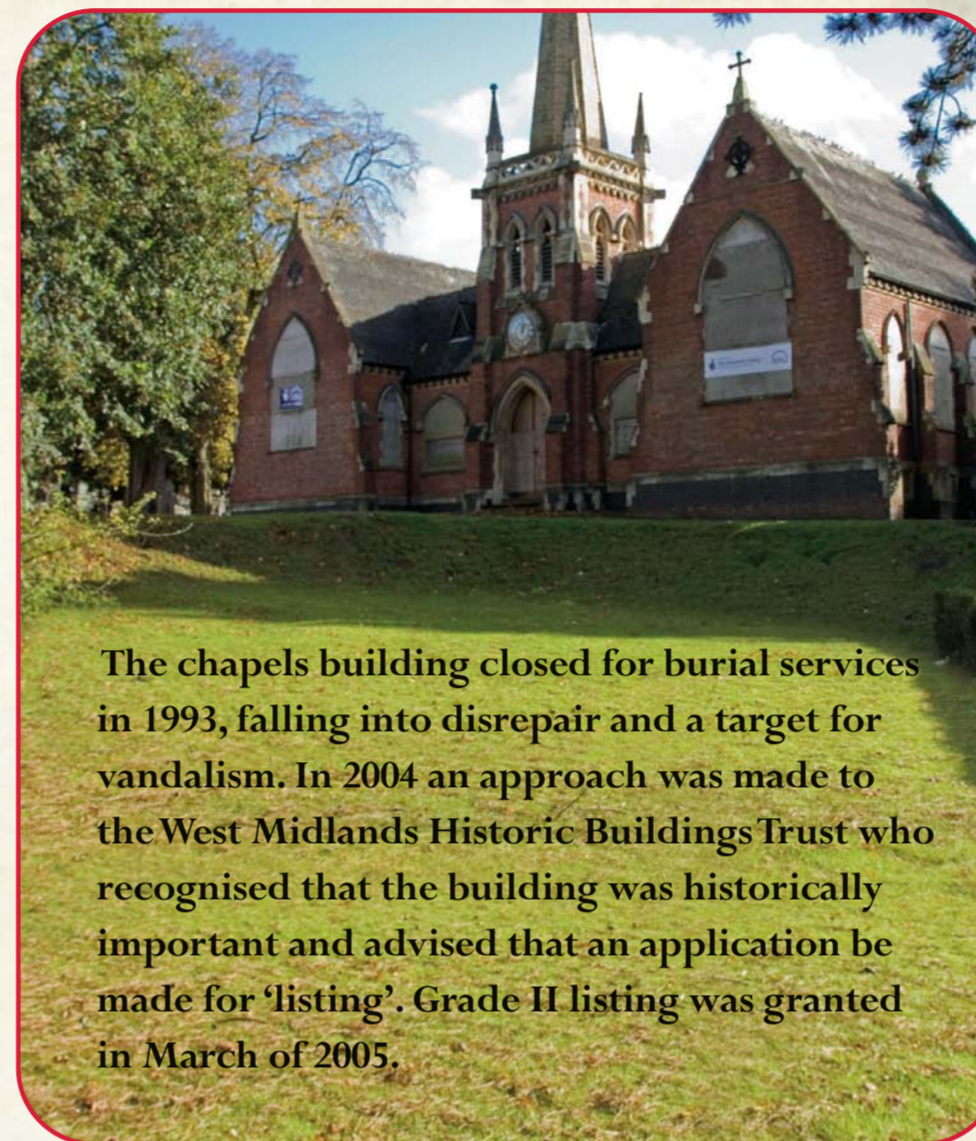

The chapels building closed for burial services in 1993, falling into disrepair and a target for vandalism. In 2004 an approach was made to the West Midlands Historic Buildings Trust who recognised that the building was historically important and advised that an application be made for 'listing'. Grade II listing was granted in March of 2005.

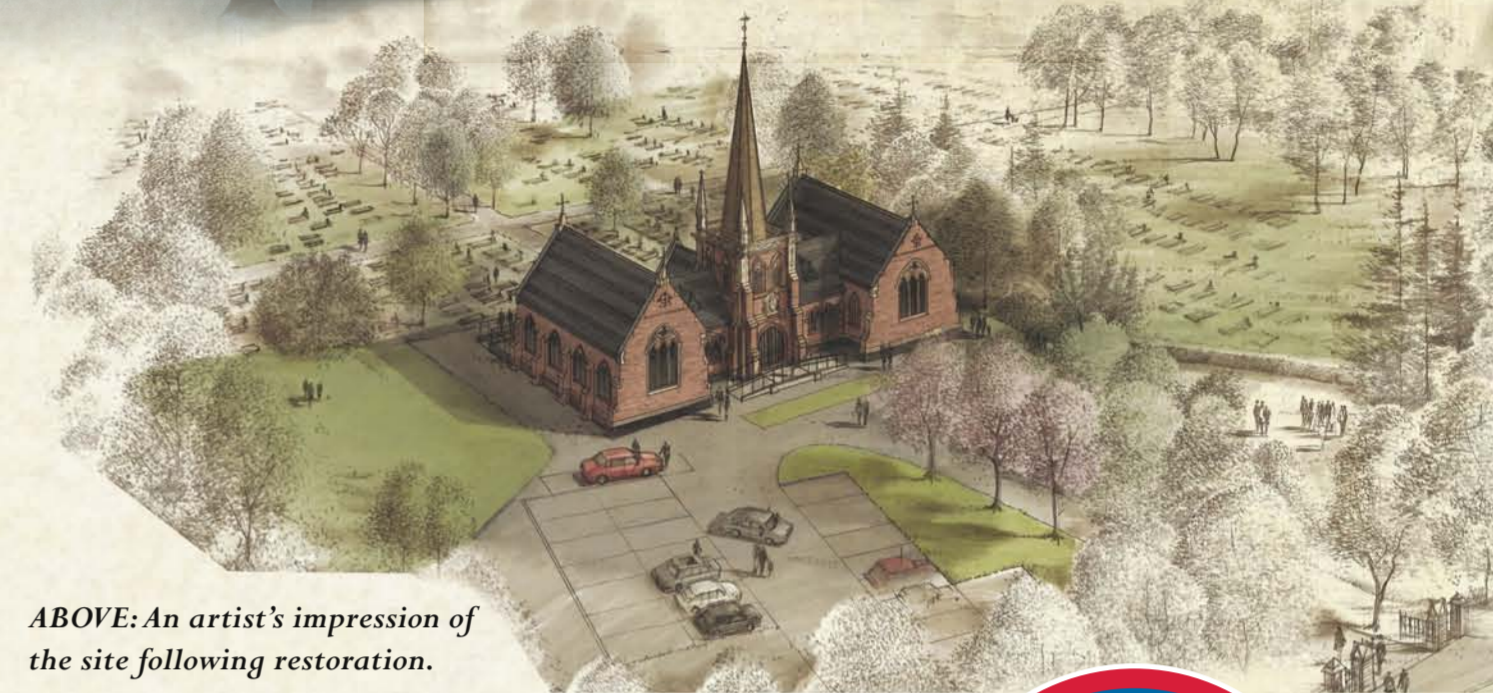

ABOVE: An artist's impression of the site following restoration.

The building was acquired by the Trust on 31st March 2014 and, with funding from the HLF and other sources, work began in 2015 to renovate the building for use as a Citizenship and Registration Office for the Dudley Borough.



ABOVE: The clock, installed in 1912 by A. Webb Ltd of Lye to celebrate the coronation of King George V.

ABOVE: Look out for the marker which denotes the start of the Cemetery History Trail, located just a little further along the path. Trail leaflets are available from Lye Library.

BELOW: The new stained glass windows created by glass artist, Paul Floyd, following designs inspired by pupils at Redhill Primary School - left - and the students at BMETC Art & Design College and Kidderminster Academy.

BELOW: The beautifully restored weather vane showing the original construction date of 1878.



Discover more about the restoration of the Chapels

See photographs taken throughout the restoration process, together with images of the Thomas Robinson building interior as it is today.

RIGHT: An artist's impression of the Ceremony Room by the architects, Brownhill Hayward Brown.



WEST MIDLANDS Historic Buildings Trust

Supported by The National Lottery through the Heritage Lottery Fund

heritage lottery fund